

110mm, GM110ZYT Series Brush DC Motor

- General Specification

Item	Specifications
Voltage Range	24v DC (up tp 220V available)
Power Output Range	250 to 600 Watts
Speed Range	up to 9,000 rpm
Operational Temperature	-20°C to +40°C



- Technique Specifications

Part No.	Voltage	Rated Power	Rated Speed	Rated Torque		Rated Current	No Load Current	No Load Speed	Length
				Oz-in	Nm				
Units	V	W	rpm	Oz-in	Nm	A	A	rpm	mm
GM110ZYT200-12V	12	283	2700	141.6	1.0	34.6	4.9	3270	200
GM110ZYT200-24V	24	514	3070	226.6	1.6	26.0	2.6	3350	200
GM110ZYT200-48V	48	553	3300	226.6	1.6	14.3	2.5	3300	200

- Dimensions (mm)

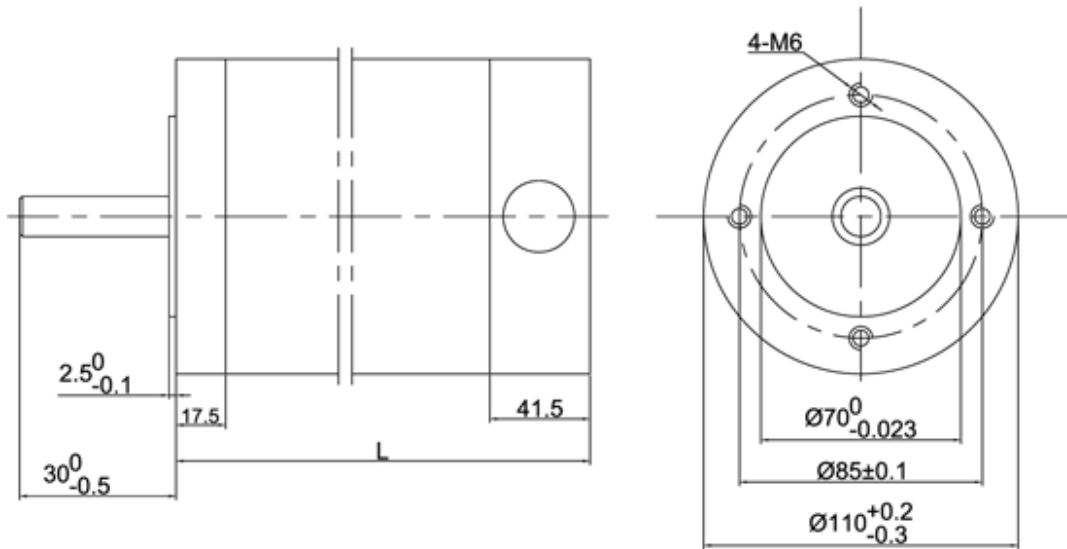

- Custom Motor Options

Custom housing to meet your dimensional requirements

Custom shaft options: extended, slotted, cross drilled, hollow shaft etc

Custom winding to meet your specific application needs

Lead wire options: special lengths, heat shrink, Teflon leads, pins, connectors, cable harnesses etc

Bearing & lubricant options for high temperature/humid operations

Encoders, gearboxes, sprockets and pulleys installation